



Pets as Gifts? Yes!

Read the research

Debunk the myth

Give it a try

[ASPCApro.org/gifts](https://www.aspcapro.org/gifts)

ASPCA[®]
WE ARE THEIR VOICE.[®]

ENJOY THE MUSIC

The webinar begins at the top of the hour.

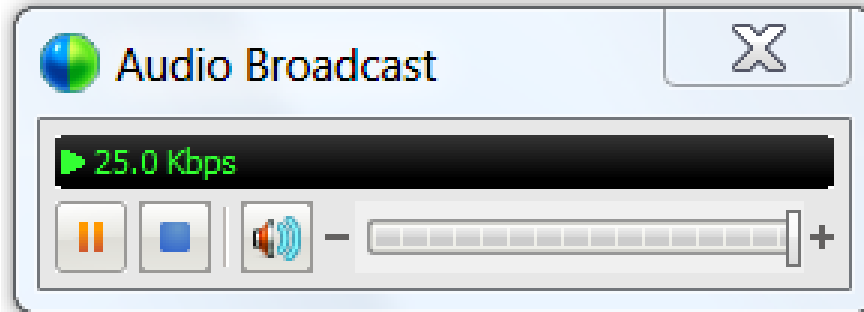

Turn up your computer speakers!
**Audio Broadcast should open automatically in
top left corner of your screen.**

If you have audio issues:

- Click **Communicate** at top left of screen
- Click **Audio Broadcast**

HOW TO CHAT

- 1 Type your message in the **small** chat box.
- 2 In the Send To box, use the drop down triangle to select **All Participants**
- 3 Click Send when ready!

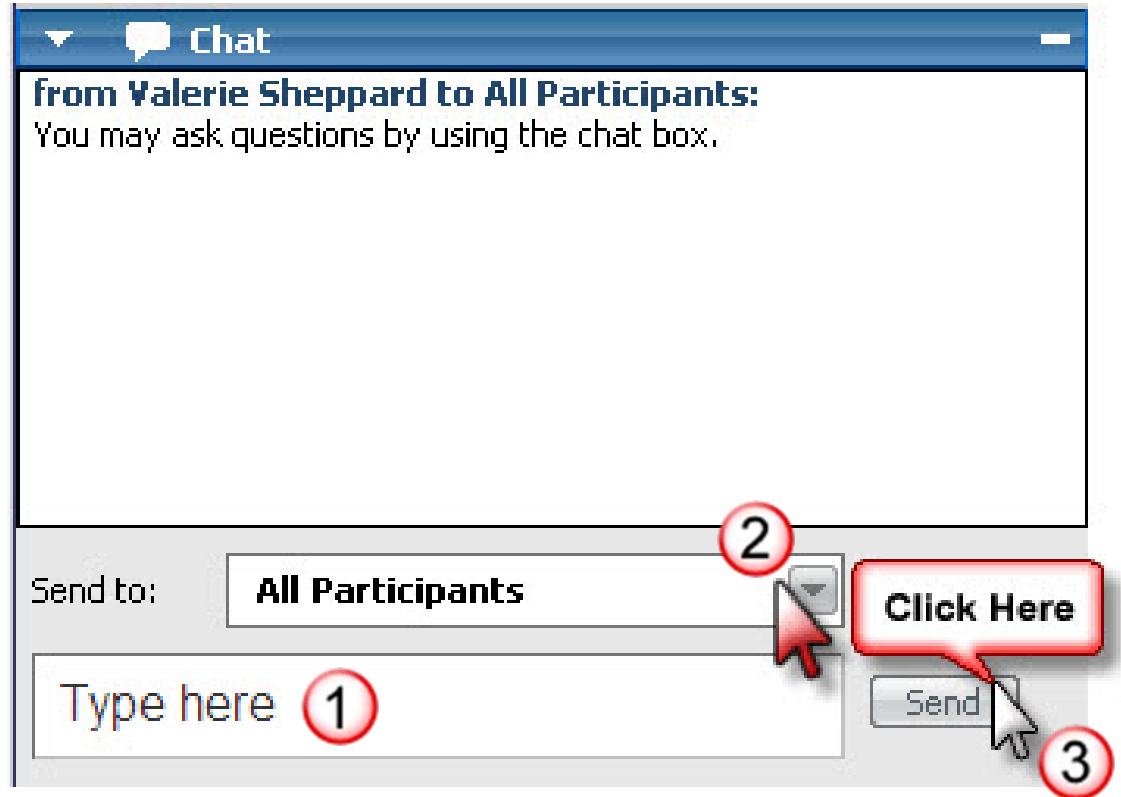

Blog

Subscribe

Get the ASPCA Professional Blog direct to your inbox.

Type Email Address

Preview Feed

Submit

Recent Comments

Great article but it would have helped to keep the same color scheme between the two figures (i.e. 2010...

By Dr. Julie M. Faleis on My Neighbor Sougilt a Puppy OT the Intenal - 4/11/2014 at 7:44pm

A historic meet-up people breed litter of emuffs

Pets As Gifts—Wrap ‘Em

BLOG | Thursday, November 7 2013 | Dr. Emily Weise

Share 1.6k

Dr. Emily Weise puts a tired old myth to bed

"He called to me from over the fence as I was sitting in the yard. His arms was something blond and chubby... like a big butter... you!" he exclaimed.

My head raced—A PUPPY?! What... are you NUTS? And then I saw a puppy, and she looked at me, all soft blubbery dog of her name... I'm Bean.

Bean came into my life as a gift—a completely unexpected surprise. I have been so fortunate to have had more than one "once in a lifetime" was always ready for some fun—a great running partner and a great diagnosis of MG; when I was feeling scared and sorry for myself, she

Animals 2013, 3, 995-1001; doi:10.3390/ani3040995

OPEN ACCESS
animals
ISSN 2076-2615
www.mdpi.com/journal/animals

Communication

Should Dogs and Cats be Given as Gifts?

Emily Weise^{1*}, Emily D. Dolan², Laurie Garrison³, Julie Hong⁴ and Margaret Slater⁵

- ¹ Shelter Research and Development, Community Outreach, American Society for the Prevention of Cruelty to Animals (ASPCA[®]), 3201 SW Winding Way, Palm City, FL 34990, USA
- ² Shelter Research and Development, Community Outreach, American Society for the Prevention of Cruelty to Animals (ASPCA[®]), P.O. Box 821075, Kenosha, WA 98028, USA;
- ³ Shelter Research and Development, Community Outreach, American Society for the Prevention of Cruelty to Animals (ASPCA[®]), P.O. Box 408, Little Silver, NJ 07739, USA;
- ⁴ E-Mail: emily.dolan@aspca.org
- ⁵ Research and Analytics, Media & Communications, American Society for the Prevention of Cruelty to Animals (ASPCA[®]), 520 Eighth Avenue, 7th Floor, New York, NY 10018, USA;
- ⁶ E-Mail: julie.hong@aspca.org
- ⁷ Shelter Research and Development, Community Outreach, American Society for the Prevention of Cruelty to Animals (ASPCA[®]), 50 Stone Ridge Drive, Florence, MA 01062, USA;
- ⁸ E-Mail: margaret.slater@aspca.org

* Author to whom correspondence should be addressed; E-Mail: emily.weise@aspca.org
Tel.: +1-917-574-7533.

Received: 12 September 2013; in revised form: 2 October 2013 / Accepted: 3 October 2013
Published: 16 October 2013

Simple Summary: Policies that state pets should not be adopted as gifts are prevalent at animal welfare organizations, despite the fact that this belief is unfounded. Denying adopters who intend to give the animals as gifts may unnecessarily impede the overarching goal of increasing adoptions of pets from our nation's shelter system. We found that receiving a dog or cat as a gift was not associated with impact on self-perceived love/attachment, or whether the dog or cat was still in the home. These results suggest there is no increased risk of relinquishment for dogs and cats received as a gift.

Abstract: Policies that state dogs and cats should not be adopted as gifts are prevalent at animal welfare organizations, despite the fact that this belief is unfounded. Denying adopters who intend to give the animals as gifts may unnecessarily impede the overarching

of dogs and cats from our nation's shelter system that receiving a dog or cat as a gift was not self-perceived love/attachment, nor was it had the dog or cat in the home. The results suggest that there is no increased risk of gift.

relinquishment, pet attachment

are extremely common in the field of animal welfare ranging from veterinary organizations and shelters like the Santa Barbara Humane Society. The reasoning behind this policy may, at least in part, include statements such as: pet ownership is a commitment; pet ownership is costly; the cost of pet ownership may be driven by concerns of relinquishment; and relinquishment occurs frequently. However, the

be relinquished to shelters at a high rate. We found that half of all dogs and cats who were adopted as gifts is lower than from

approximately 2,600 dogs and 2,300 cats that dogs relinquished to shelters infrequently came from a pet shop (ORs range from 1.5 to 2.0), and from a pet shop (ORs range from 1.5 to 2.0); cats that were relinquished infrequently. Relinquished cats

the odds of cat relinquishment were higher than for dogs. The odds of cat relinquishment were higher than for dogs. The odds of cat relinquishment were higher than for dogs.

in addition, Scarlett *et al.* identified 71 reasons given for pet relinquishment [7]. "Unwanted gift" was listed as a reason for only 0.3% of dogs and 0.4% of cats entering the shelters surveyed, compared with

ASPCApro.org/giftpets – research

ASPCApro.org/gifts – download tips



Emily Weiss, PhD, CAAB

Vice President Shelter Research
and Development

ASPCA

emily.weiss@aspca.org

Pets as Gifts? Wrap 'em up!



Starting with a Poll

Answer the poll question in the right column
of your screen

Does the organization you work with allow pets
to be adopted as gifts?

- Yes
- No
- Only in special situations

And Another Quick Poll

Answer the poll question in the right column of your screen

How many of you received a pet as a gift at some point in your life?

- I did!
- No way!
- I didn't but I sure wish I had...

W Pets as gifts? Not a good idea, experts say

ts



By **Kathleen Poliquin** | kpoloquin@syracuse.com

on December 04, 2012 at 2:00 AM, updated December 04, 2012 at 2:01 AM



Getty Images / Stock photo

If you are thinking about giving someone a pet as a holiday gift, most animal experts suggest you think again.

While the excitement of surprising a loved one with an adorable puppy or kitten may be tempting, pets are not like a sweater or piece of jewelry that can be easily returned or re-gifted.

"Pet ownership is not an impulse to jump into," Dr. Mollie Hurley, of **Stack Veterinary Hospital in Onondaga**, said. "And by not



ASPCApro.org

What They Say...

Animals given as presents often end up unwanted and discarded at the local shelter.

Adding a pet to the family is a long-term commitment. It's a decision that needs input from everyone who would care for the animal. That's why pets should not be given as holiday gifts.

They will be more likely to relinquish the pet if they get him as a gift

Giving a pet as a gift is not a good idea

What This Means for Dogs and Cats in Shelters



What the Data Tells Us...

Dogs obtained as gifts are less likely to be relinquished than dogs obtained from a shelter, a friend, as a stray or from a pet shop. (New et al, 2000)

Cats obtained as gifts are less likely to be relinquished than those that are obtained from a shelter, a friend, as a stray or from a pet shop. (New et al, 2000)

Pets are rarely relinquished because they are a unwanted gift (Scarlett, 1999)

Dogs received as gifts are significantly less at risk for relinquishment compared to those that were purchased or adopted (Patronek, 1996)

But... For Some the Data was Ignored...

“As X notes, a companion animal issues specialist, says, "It's important to remember that animal shelters, and their innocent charges, will suffer the effects of impulse purchases of pets as gifts. Deciding whether one has the time and resources to add a pet to the family needs to be made after careful thought. We need to remember that pets can't simply be returned or discarded like a broken toy.” (Better Homes and Gardens)

Adorable...



But **DON'T** do it!



What are **you**
returning this
holiday season?
Sweaters don't die when returned.
DOGS ARE NOT GIFTS.



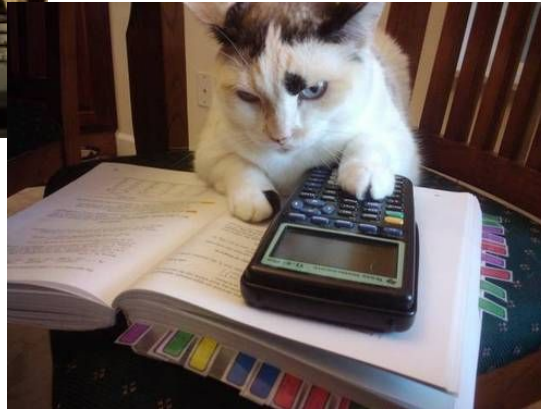





What We Did

In an omnibus survey, we reached 222 respondents who reported they received a dog or cat as a gift in the past 10 years or so.

We asked 3 questions to those respondents...

3 Questions Asked

1. Were you involved, in any manner, in the selection process of the pet that you received as a gift?
 - Yes, you were involved
 - No, you were not involved but you wish you were involved
 - No, the pet was a surprise and that was okay
2. Did receiving a pet as a gift increase, decrease or have no impact on your love or attachment to the pet?
3. Is that pet still with you?
 - Yes
 - No, he or she passed away
 - No, the pet has another home

Did receiving a pet as a gift increase, decrease or have no impact on your love or attachment to the pet?

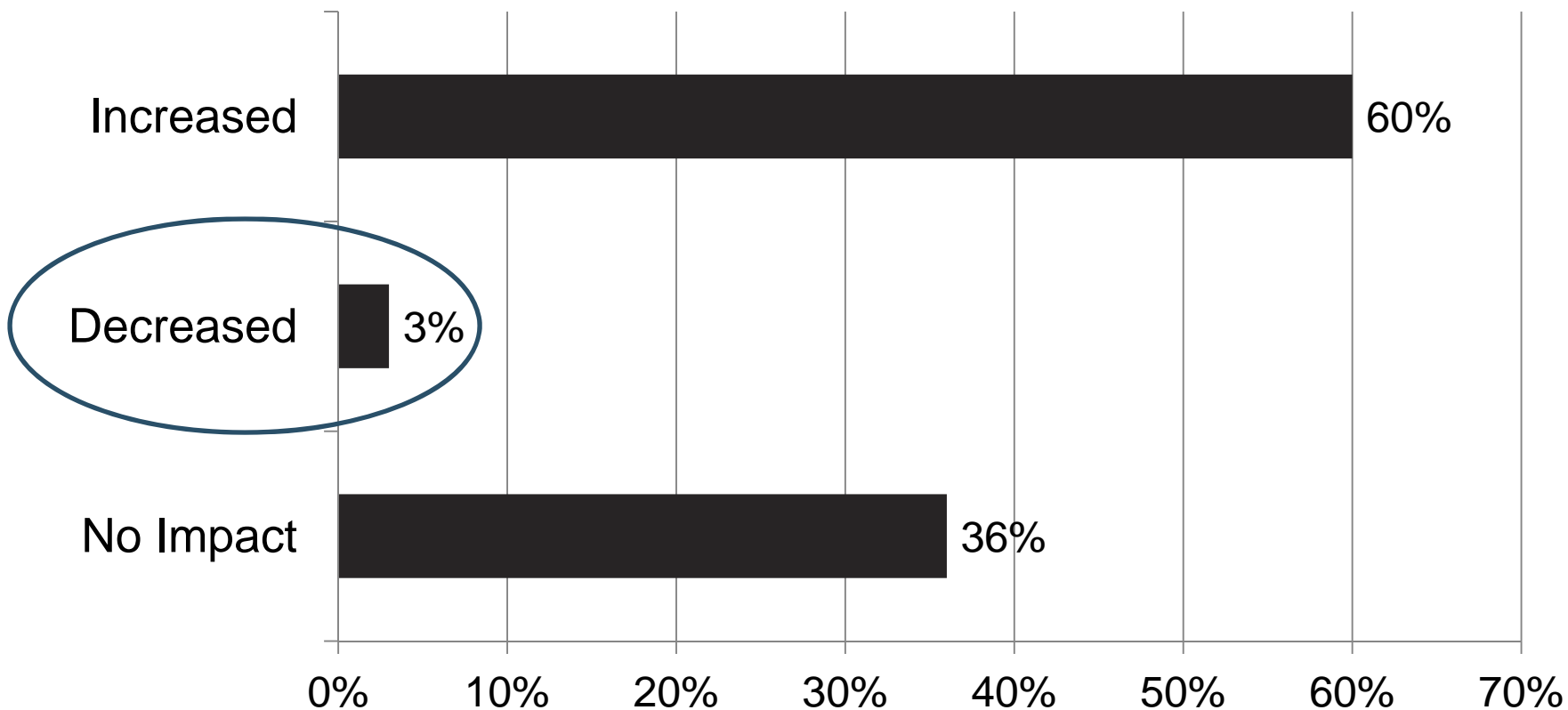

Were you involved in the selection process of the pet that you received as a gift?

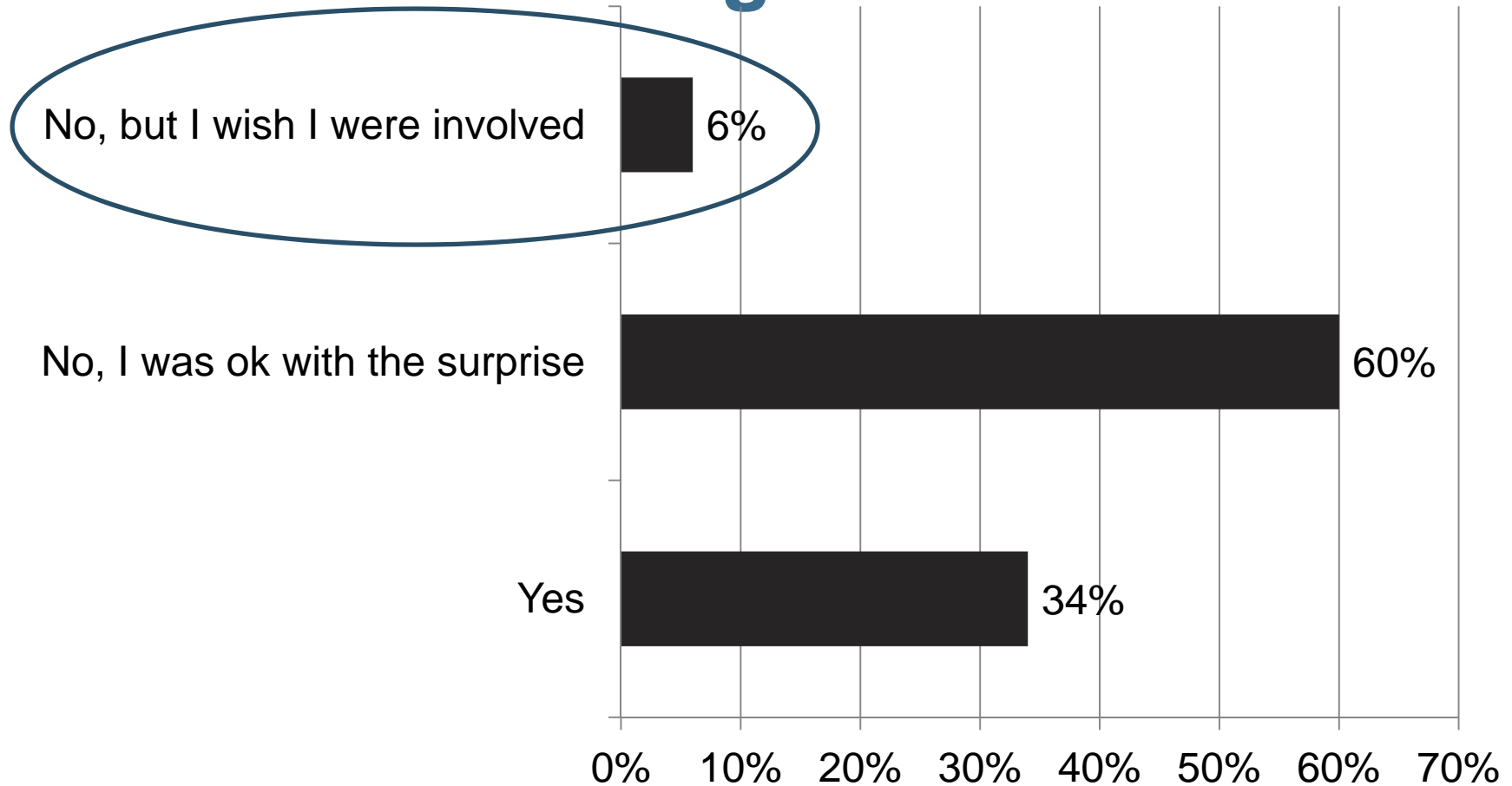

What We Found

No significant relationship between receiving a dog or cat as a gift, whether a surprise or not, and the receivers reported love or attachment for the pet



Is that pet still with you?

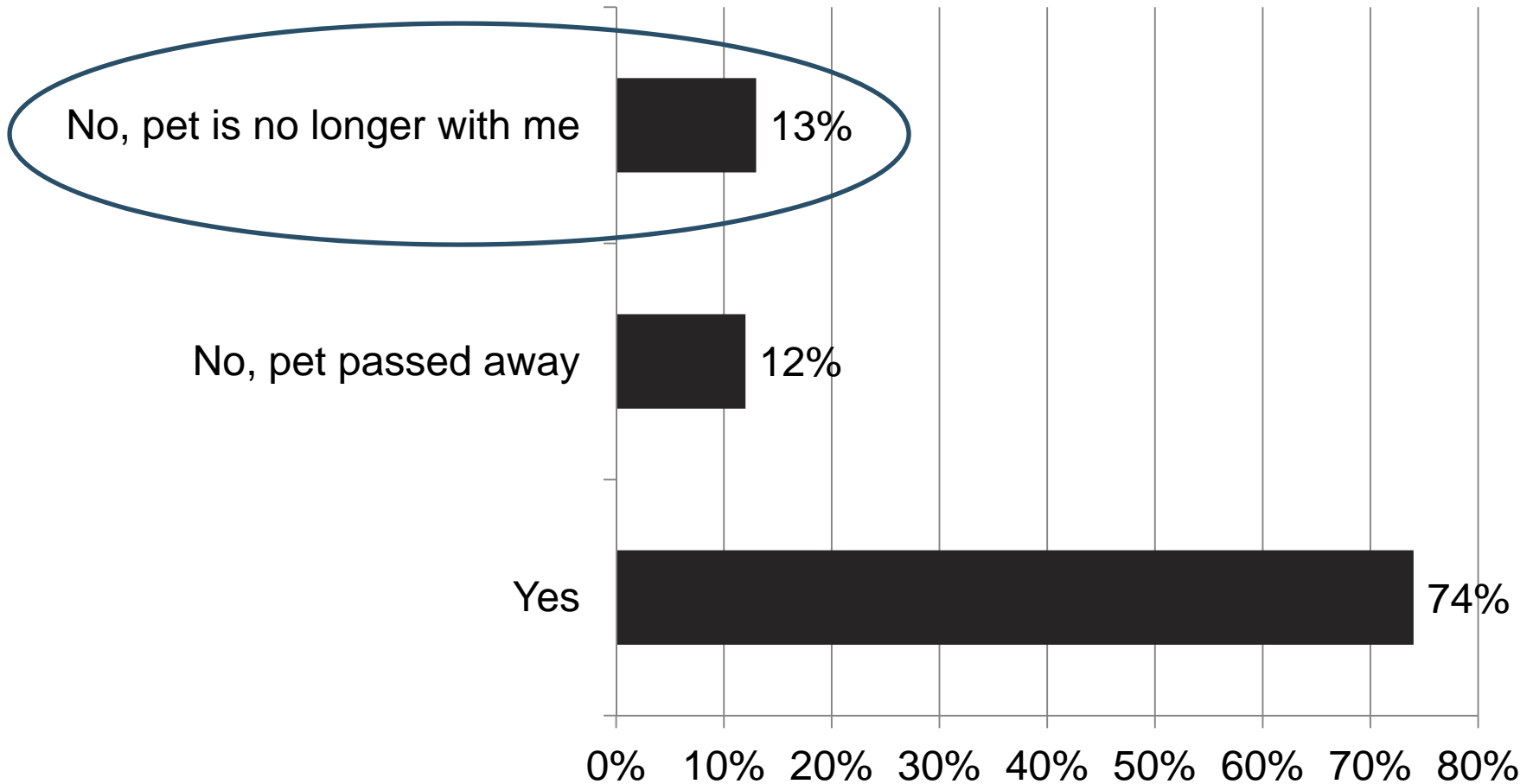

No significant relationship between receiving a dog or cat as a gift as a surprise or not and whether the pet was still living in the home



Our Research Was Published

Animals **2013**, *3*, 995-1001; doi:10.3390/ani3040995

OPEN ACCESS

animals

ISSN 2076-2615

www.mdpi.com/journal/animals

Communication

Should Dogs and Cats be Given as Gifts?

Emily Weiss ^{1,*}, Emily D. Dolan ², Laurle Garrison ³, Julie Hong ⁴ and Margaret Slater ⁵

What are your questions about this research?



What about Dogs and Cats Under the Tree?



Pittsburgh Delivers!

*Adopt
a pet...*



*...we'll deliver
Christmas Day!*



Special Delivery in Santa Fe



SPECIAL DELIVERY!
Make their holidays bright!

Adopt any animal from the Santa Fe Animal Shelter – dog, cat, snake or rabbit – by Dec. 23 and have Santa Claus and his elf deliver your new friend on Christmas Eve.



**Call 983-4309, ext. 610
for more details.**



santa fe animal shelter
100 Caja del Rio Road, Santa Fe
983-4309 sfhumanesociety.org



Greater Androscoggin HS, Maine

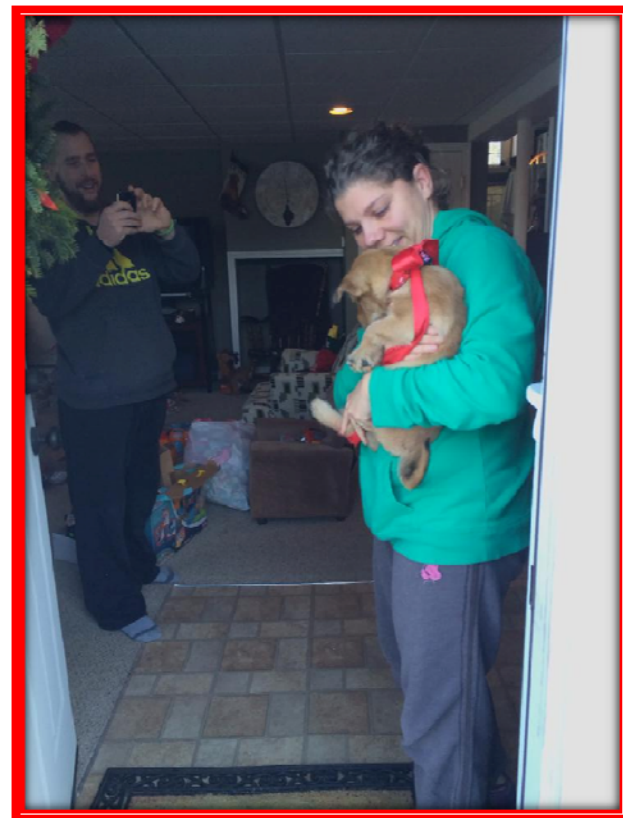
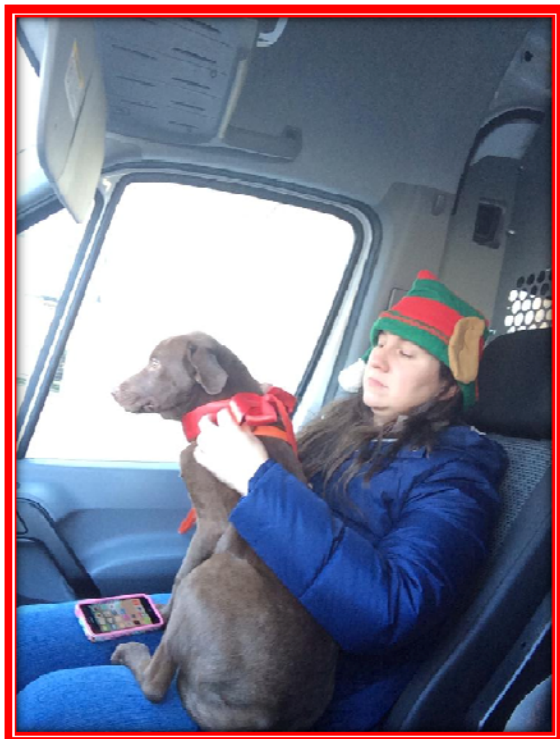

Happy Holidays!

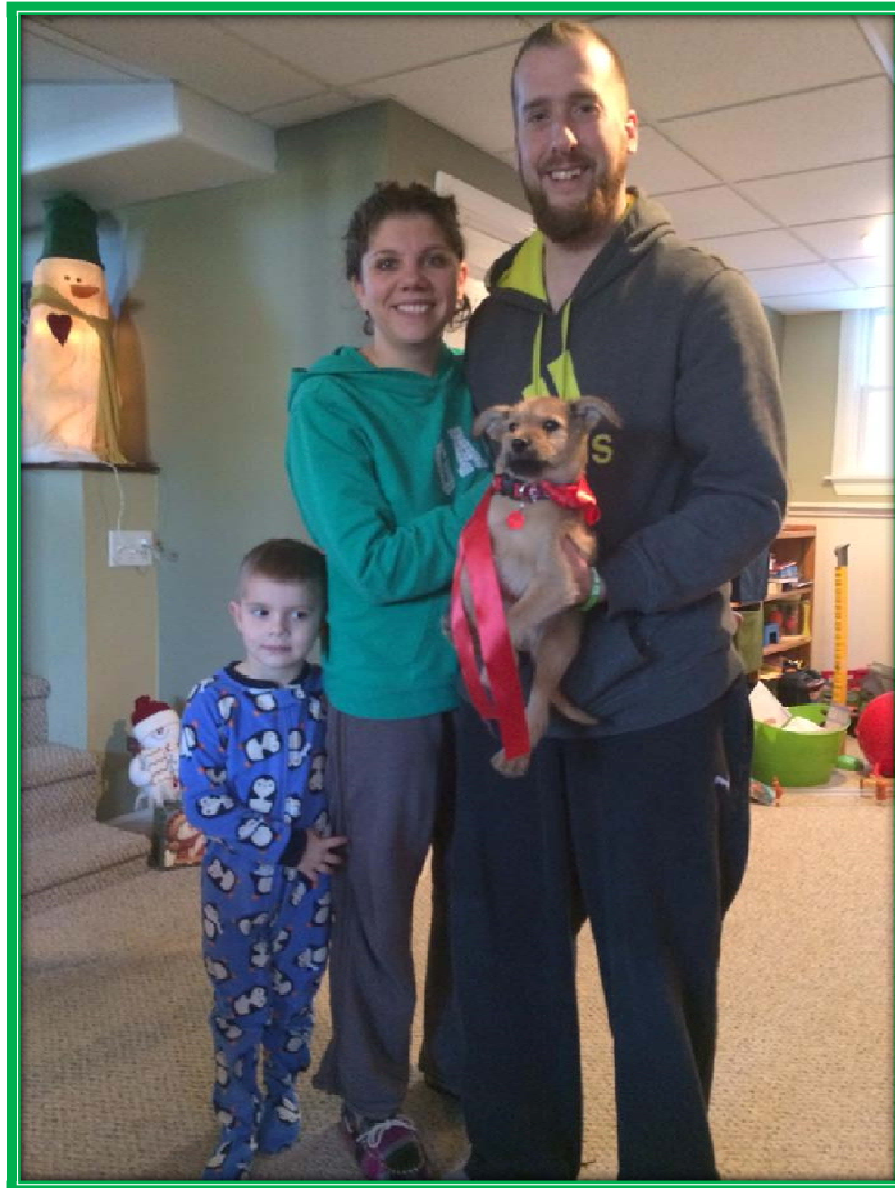



Like · Comment

 Angela Curtis, Kara Hersom, Jenny Roderick and 1,284 others like this.

 23 shares



Lars Forsberg Merry Christmas 😊

25 December 2013 at 06:06



Barbara Parker Awwwwwwwwwwww 

25 December 2013 at 06:07



Stephanie Lynn Rowe Awe Merry Christmas and congratulations!

25 December 2013 at 06:08



Audrey Amidon This is just such a wonderful idea!

25 December 2013 at 06:10 ·  4



Oliver O Kay very proper...

25 December 2013 at 06:11



Hillary Foster So sweet! Merry Christmas!

25 December 2013 at 06:12



Laura Evans What a great gift for a shelter pet, a family and a furever home of their own. I bet all the pets asked Santa for kind people for Christmas.

25 December 2013 at 06:16 ·  2

How can you be sure the gift receiver will be a good match?



How do you convince staff and other stakeholders?



© 2014 ASPCA®. All Rights Reserved.

Pets as Gifts? Yes!

Read the research
Debunk the myth
Give it a try

ASPCApro.org/gifts

ASPCA[®]
WE ARE THEIR VOICE.[®]

ASPCA[®]
ASPCApro.org

**Now that you have heard the information
supporting adopting pets as gifts,
are you considering giving it a go?**

Answer in the chat panel



Blog

Subscribe

Get the ASPCA Professional Blog direct to your inbox.

Type Email Address

Preview Feed

Submit

Recent Comments

Great article but it would have helped to keep the same color scheme between the two figures (i.e. 2010...

By Dr. Julie M. Faleis on My Neighbor Sougilt a Puppy OT the Intenal - 4/11/2014 at 7:44pm

A hissing meow as people breed litter of emuffs

Pets As Gifts—Wrap ‘Em

BLOG | Thursday, November 7 2013 | Dr. Emily Weise

Share 1.6k

Dr. Emily Weise puts a tired old myth to bed

"He called to me from over the fence as I was sitting in the yard. His arms was something blond and chubby... like a big butter... you?" he exclaimed.

My head raced—A PUPPY?! What... are you NUTS? And then I saw a puppy, and she looked at me, all soft blubbery dog of her name... I'm Bean.

Bean came into my life as a gift—a completely unexpected surprise. I have been so fortunate to have had more than one "once in a lifetime" puppy, and she looked at me, all soft blubbery dog of her name... I'm Bean. Bean was always ready for some fun—a great running partner and a great diagnosis of MG; when I was feeling scared and sorry for myself, she

Animals 2013, 3, 995-1001; doi:10.3390/ani3040995

OPEN ACCESS
animals
ISSN 2076-2615
www.mdpi.com/journal/animals

Communication

Should Dogs and Cats be Given as Gifts?

Emily Weise^{1*}, Emily D. Dolan², Laurie Garrison³, Julie Hong⁴ and Margaret Slater⁵

- ¹ Shelter Research and Development, Community Outreach, American Society for the Prevention of Cruelty to Animals (ASPCA[®]), 3201 SW Winding Way, Palm City, FL 34990, USA
- ² Shelter Research and Development, Community Outreach, American Society for the Prevention of Cruelty to Animals (ASPCA[®]), P.O. Box 821075, Kenosha, WA 98028, USA
- ³ Shelter Research and Development, Community Outreach, American Society for the Prevention of Cruelty to Animals (ASPCA[®]), P.O. Box 408, Little Silver, NJ 07739, USA
- ⁴ Research and Analytics, Media & Communications, American Society for the Prevention of Cruelty to Animals (ASPCA[®]), 520 Eighth Avenue, 7th Floor, New York, NY 10018, USA
- ⁵ Shelter Research and Development, Community Outreach, American Society for the Prevention of Cruelty to Animals (ASPCA[®]), 50 Stone Ridge Drive, Florence, MA 01062, USA

* Author to whom correspondence should be addressed; E-Mail: emily.weise@aspca.org
Tel.: +1-917-574-7533

Received: 12 September 2013; in revised form: 3 October 2013 / Accepted: 3 October 2013
Published: 16 October 2013

Simple Summary: Policies that state pets should not be adopted as gifts are prevalent at animal welfare organizations, despite the fact that this belief is unfounded. Denying adopters who intend to give the animals as gifts may unnecessarily impede the overarching goal of increasing adoptions of pets from our nation's shelter system. We found that receiving a dog or cat as a gift was not associated with impact on self-perceived love/attachment, or whether the dog or cat was still in the home. These results suggest there is no increased risk of relinquishment for dogs and cats received as a gift.

Abstract: Policies that state dogs and cats should not be adopted as gifts are prevalent at animal welfare organizations, despite the fact that this belief is unfounded. Denying adopters who intend to give the animals as gifts may unnecessarily impede the overarching

of dogs and cats from our nation's shelter system that receiving a dog or cat as a gift was not self-perceived love/attachment, nor was it associated with whether the dog or cat was still in the home. The results suggest there is no increased risk of relinquishment, pet attachment

ASPCApro.org/giftpets – research

ASPCApro.org/gifts – download tips